

Job or File name
Date sent
Sent to (Name)

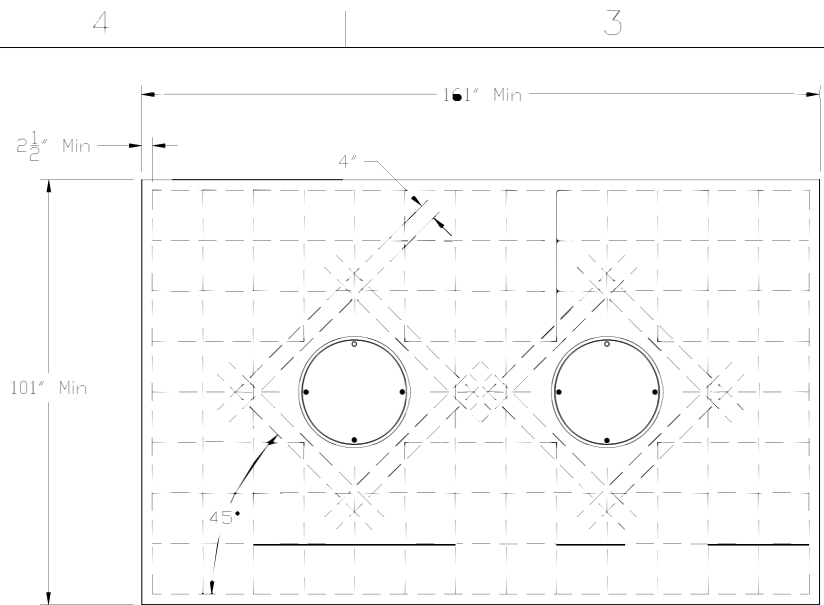

**CONCRETE SLAB DETAIL FOR
H2O/HS2O LOAD RATING**

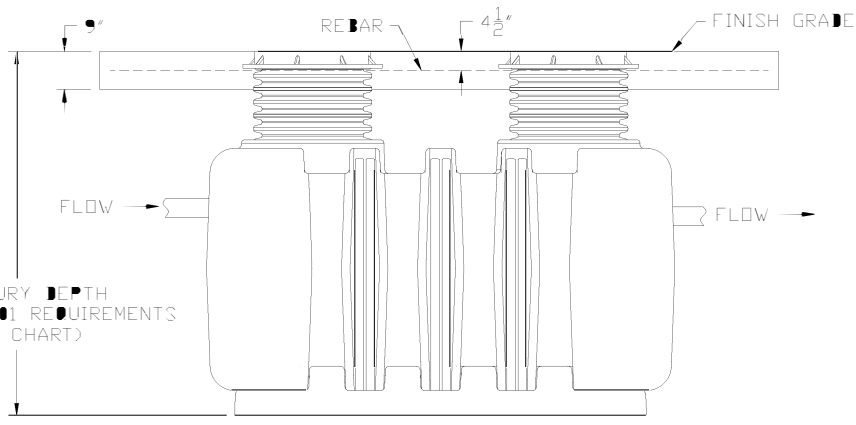

MAX. BURY DEPTH
PER ANSI Z1001 REQUIREMENTS
(SEE CHART)

Tank Capacity (gal)			MAX. BURY DEPTH (FT)
500			17
750			16
1000			16
1300			16
1500			13

REVISIONS				
ZONE	REV	DESCRIPTION	DATE	APPROVED
ALL	0	RELEASE	DATE	JG

INTERCEPTORS

1. Inlet and Outlet No-Hub Connections.
2. H2O Load Rated Access Covers.
3. Maximum Operating Temperature: 190° Continuous.

DETAILS

- Certified by CSA and IAPMO to ASME A112.14.3 and ANSI Z1001.
- Factory installed internal piping.
- 3/8" thick seamless high density polyethylene.
- Full internal access through lids.
- Vent not required for proper operation.
- Designed for above or below ground installations.
- Integral Anti-siphon Air Relief port.

SUFFIX

- AK
- C
- DP
- EP
- F6
- HLA

OPTIONAL VARIATIONS

- High water anchor kit
- Lid extensions (specify)
- Dosing pump
- Enzyme port
- 6" No Hub inlet/outlet connection
- High level alarm

INSTRUCTIONS FOR BELOW GRADE INSTALLATION

EXCAVATION

1. Install the interceptor(s) as close as practical to the fixtures being served.
2. The excavation must be a minimum of 18" greater on all sides of the tank.
3. The depth of the excavation must be greater than 12" on the bottom of the interceptor.
4. Fill the interceptor with water prior to backfilling in order to prevent the interceptor from floating.
5. Fully install the double wall corrugated pipe and lid prior to backfilling.
6. Concrete or finishing material requirements is to be determined by the specifying engineer.
7. Encase the interceptor in well-packed 3/4" rock, or sand. Do not compact backfill around interceptor.
8. To prevent float out; the Anchor kit is recommended for installations in high water table conditions. This is to be determined by the specifying engineer.

NOTES:

- Concrete to be 28 day compressive strength to 4000psi.
- No. 4 rebar (1/2"Ø) grade 60 steel per ASTM A615 connected with wire
- Rebar to be 4" from face of concrete.
- Rebar spacing 12" grid, 4" spacing around access openings.
- All penetrations to be sleeved or have slip connections.
- Minimum 18" from top of slab to top of tank.



TOWN & COUNTRY PLASTICS
Customized For Precision

DRAWN BY		SIZE COLOR/FINISH	
JG			
APPROVED BY		SCALE MAT'L	
JG			

EXCAVATION DETAILS

SHEET 1 OF