

4 3 2 1

**TOP VIEW**

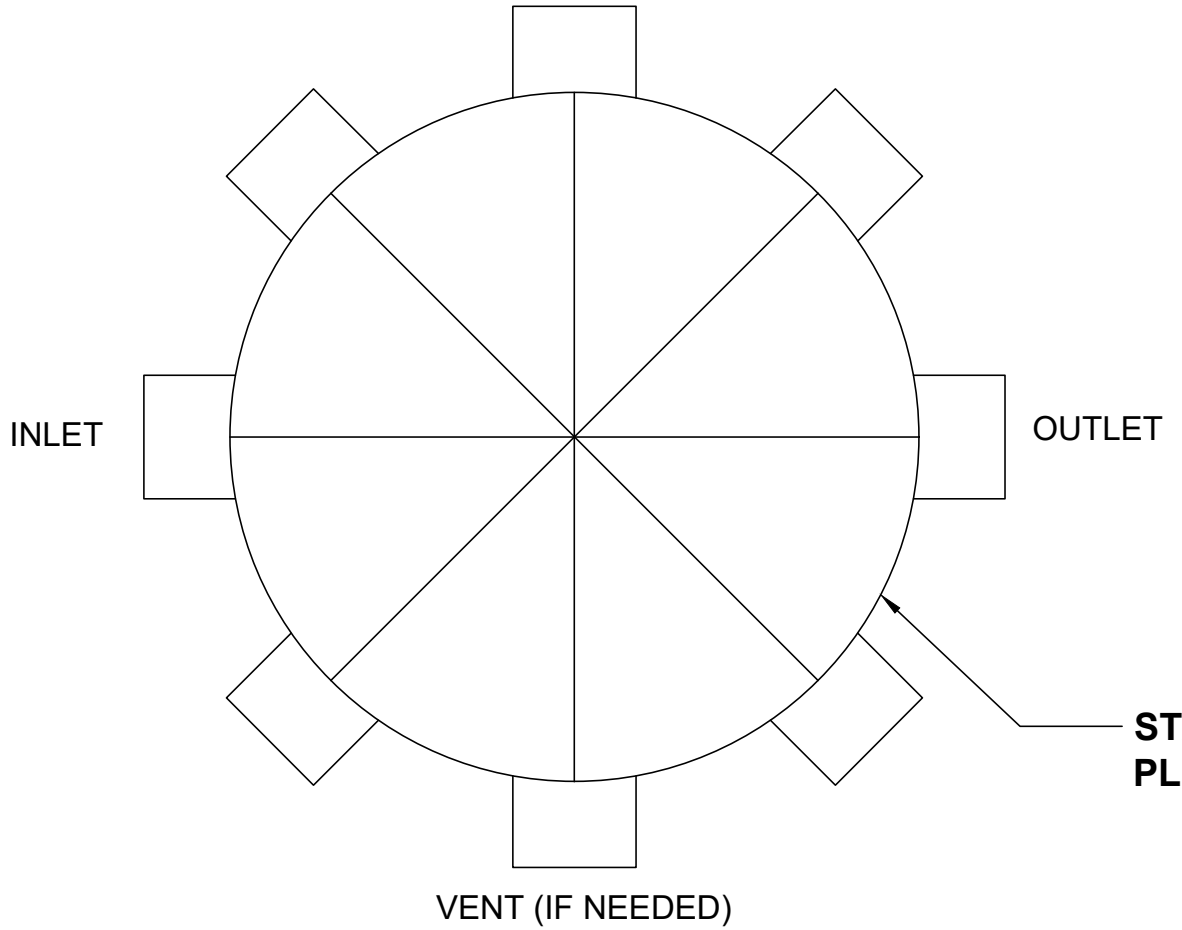

	FITTING SIZE	FITTING TYPE (MPT OR PLAIN END)	STANDARD FITTING CENTERLINES	FITTING CENTERLINE (IF DIFFERENT THAN STANDARD)
INLET			51"	
OUTLET			47"	
VENT (IF NEEDED)			54"	

STANDARD FITTING LOCATIONS SHOWN. PLEASE MAKE NECESSARY CHANGES ON TOP VIEW

BOLTED & GASKETED COVER

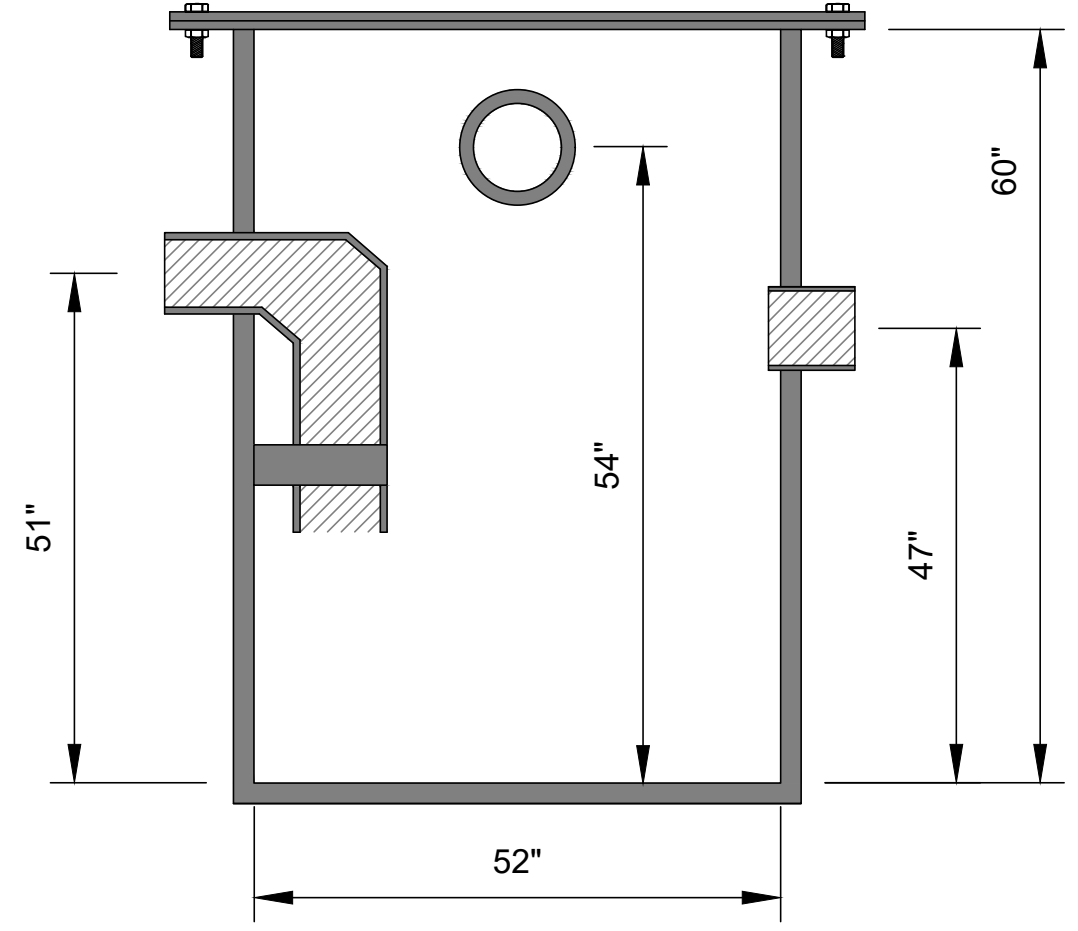

**SECTION VIEW**

TANK GALLON CAPACITY: <b>395</b>	WELDED BY:	UNLESS STATED OTHERWISE DIMENSIONS ARE IN INCHES	MATERIAL: <b>HDPE - ASTM 2148</b>			TITLE: <b>NT-500 HDPE NEUTRALIZATION TANK</b>	NT SERIES	REV:	 WWW.TANDCPLASTICS.COM 732-780-5300
TANK GALLON CAPACITY WITH LIMESTONE: <b>132</b>	COMPLETED BY:		WEIGHT [lb]: <b>225 LBS.</b>	NAME	DATE		SHEET 1 OF 1	SIZE:	
LIMESTONE REQUIRED: <b>5,000 LBS.</b>	REVIEWED BY:		DO NOT SCALE DRAWING	CHECKED	08/30/2022		SCALE: 1:2		
THE INFORMATION CONTAINED IN THIS DRAWING IS THE SOLE PROPERTY OF TOWN & COUNTRY PLASTICS LLC. ANY REPRODUCTION IN PART OR AS A WHOLE WITHOUT THE WRITTEN PERMISSION OF TOWN & PLASTICS LLC IS PROHIBITED.									

4 3 2 1